











MEETING ROOM CAPACITIES - STANDARD

											
ROOM NAME	SURFACE (SQ FT)	SURFACE (SQ M)	HEIGHT (FEET)	HEIGHT (METERS)	BANQUET	RECEPTION (Cocktail)	THEATER	CLASSROOM	BOARDROOM	U-SHAPE	CABARET
Santo Domingo Ballroom	15,403	1,431	21	6	960	1,520	2,070	840	180	207	576
Santo Domingo I	1,883	175	21	6	90	190	242	105	36	51	54
Santo Domingo II	1,840	171	21	6	90	190	242	105	36	51	54
Santo Domingo III	3,745	348	21	6	240	375	552	210	72	84	144
Santo Domingo IV	3,788	352	21	6	240	375	552	210	72	84	144
Santo Domingo V	1,829	170	21	6	90	190	242	105	36	51	54
Santo Domingo VI	1,786	166	21	6	90	190	242	105	36	51	54
Santo Domingo Foyer	10,710	995	21	6	-	1,070	-	-	-	-	-
Foyer I	1,313	122	21	6	-	130	-	-	-	-	-
Foyer II	8,105	753	21	6	-	800	-	-	-	-	-
Foyer III	1,313	122	21	6	-	130	-	-	-	-	-
Santo Domingo Terrace	5,451	506	21	6	160	273	-	-	-	-	-
Zilara Planning Office	548	51	10	3	10	-	-	-	-	-	-
Barahona	1162	108	21	6	80	140	150	66	42	33	48
Barahona I	581	54	21	6	30	70	64	33	30	30	18
Barahona II	581	54	21	6	30	70	64	33	30	30	18
Azua	1506	140	21	6	80	140	196	90	48	45	48
Azua I	753	70	21	6	50	70	72	36	30	30	30
Azua II	753	70	21	6	50	70	72	36	30	30	30
Constanza	1656	154	21	6	90	140	176	84	66	45	54
Constanza I	828	77	21	6	30	70	80	42	30	36	18
Constanza II	828	77	21	6	30	70	80	42	30	36	18
Duarte	1656	154	21	6	90	140	176	84	66	45	54
Duarte I	828	77	21	6	30	70	80	42	30	36	18
Duarte II	828	77	21	6	30	70	80	42	30	36	18
Valverde	1,506	140	21	4	80	140	196	90	48	45	48
Valverde I	753	70	21	6	50	70	72	36	30	30	30
Valverde II	753	70	21	6	50	70	72	36	30	30	30
Samana	1,162	108	21	4	80	140	150	66	42	33	48
Samana I	581	54	21	6	30	70	64	33	30	30	18
Samana II	581	54	21	6	30	70	64	33	30	30	18
Santiago (Zilara)	2,400	223	14	4	120	240	180	96	84	84	72
La Vega (Zilara)	1,162	108	14	4	50	100	90	63	36	39	30
Santiago Terrace	1,615	150	14	4	-	160	-	-	-	-	-
Rooftop Terrace	3,780	351	14	4	100	200	-	-	-	-	-
Larimar Lawn	25,000	2,322	-	-	900	2,000	-	-	-	-	-
Waves Lawn	10,170	945	-	-	150	350	-	-	-	-	-
Santiago Lawn	5,112	475	-	-	80	150	-	-	-	-	-
Zilara Beach	72,135	6,701	-	-	1,920	4,809	-	-	-	-	-
Ziva Beach	66,181	6,148	-	-	1,500	4,412	-	-	-	-	-
Central Beach	136,713	12,701	-	-	3,340	9,114	-	-	-	-	-

All stated room capacities are for maximum room sets. Event-specific room capacities may vary based on event requirements, including Audio Visual, Food & Beverage, Staging, and Entertainment. The Hyatt Ziva and Zilara Event Planning team is here to assist, and can provide diagram solutions to determine the best use of the space.

FLOOR PLANS

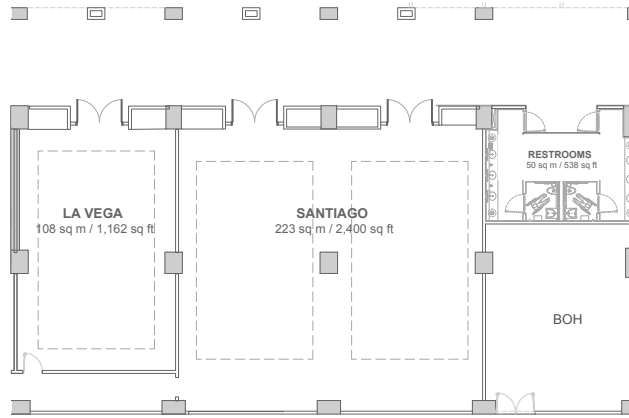
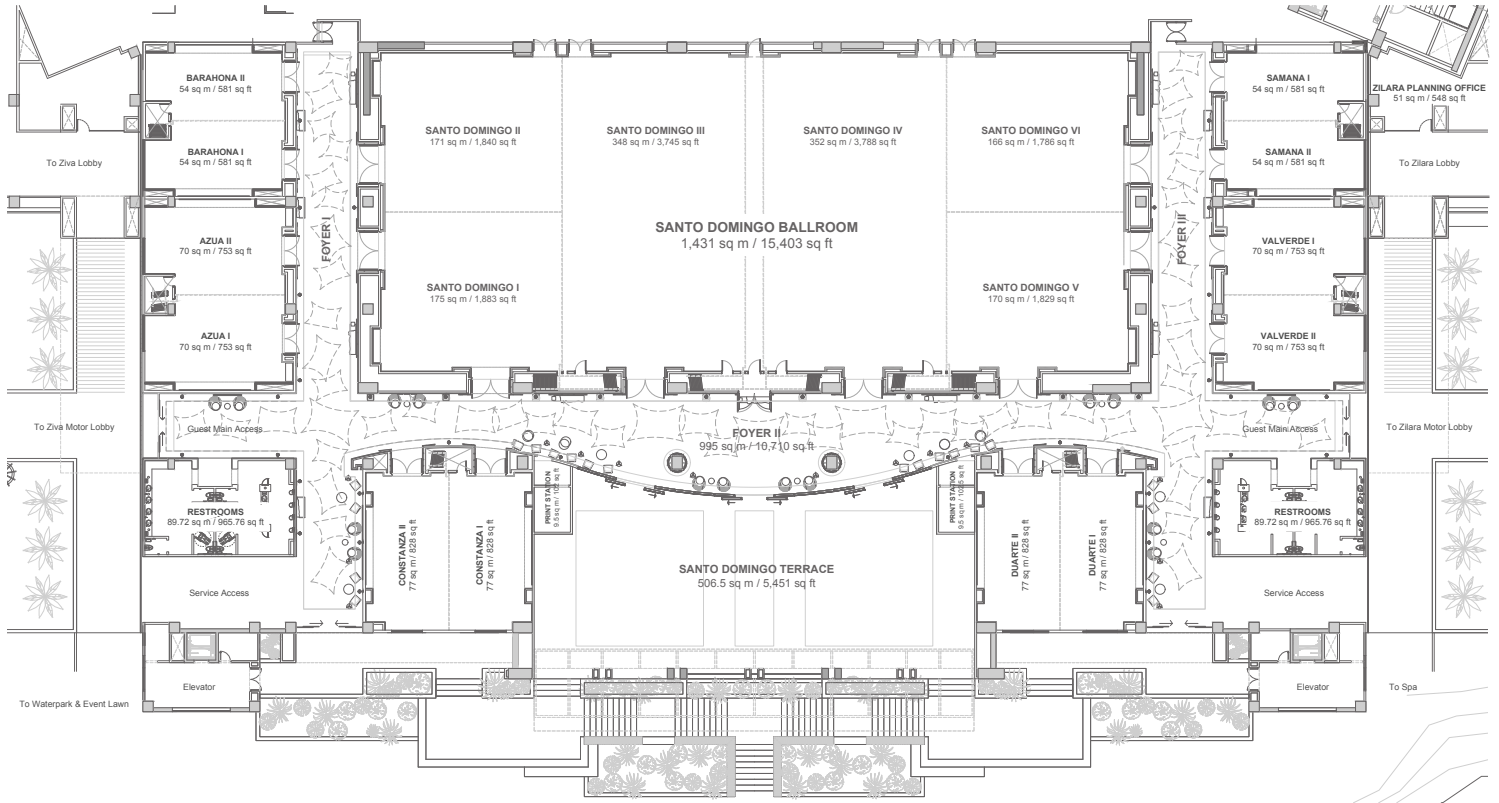

FLOOR PLANS

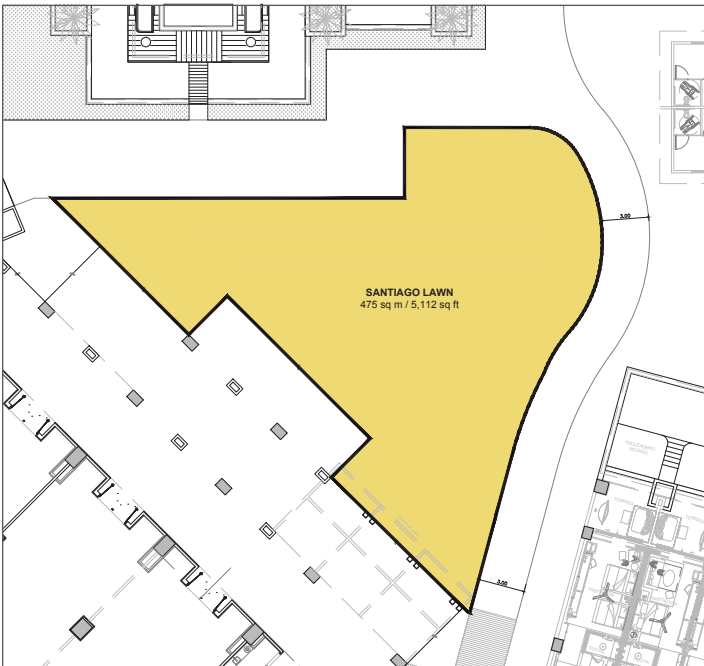
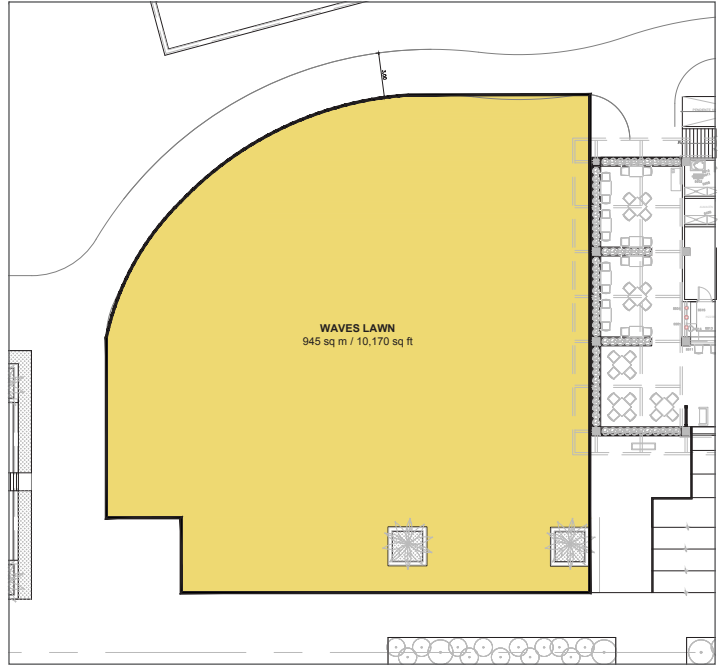
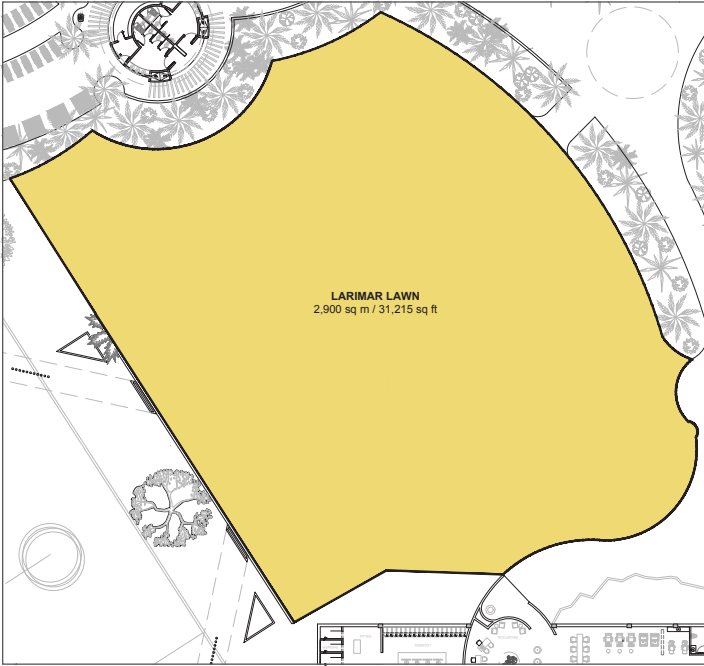

HYATT ZIVA CAP CANA

Boulevard Zona Hotelera, Playa Juanillo, Cap Cana, Rep. Dominicana
US & Canada 1-888-203-0355 | RESORTSBYHYATT.COM

©2026 Playa Management USA, LLC or its affiliates. All rights reserved. PLA00500126

ALL INCLUSIVE RESORT